



## Dead Centers FNA / FNW

### Clamping tools for clamping on machine tools

→ for large work piece centers

High degree of flexibility for clamping of work pieces with large centers.

Different types of center cones from Ø25 to Ø315, see page 16.

Special center cones up to Ø400 available upon customer's request.

#### Type FNA with morse taper

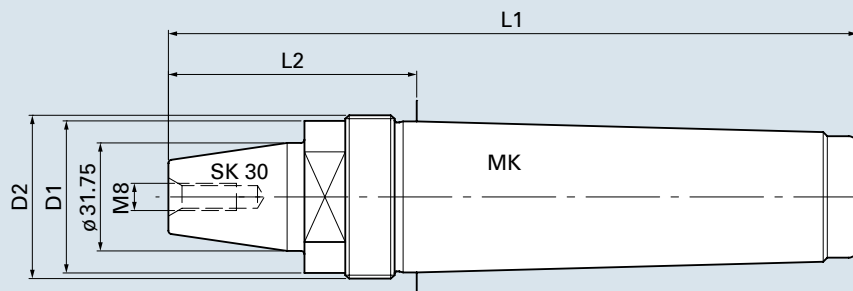

cat. no.	type	MK	D1	D2	L1	L2
92201	FNA MK3	3	32	M27 x 1.5	149	68
92202	FNA MK4	4	32	M36 x 1.5	173.5	71
92203	FNA MK5	5	45	M48 x 1.5	202.5	73
92204	FNA MK6	6	64	M68 x 1.5	263.5	81.5

- true running accuracy at center cone: max. 0.01

→ maximum flexibility

The adaptation of various changeable inserts ensures a high degree of flexibility and saving of costs.

Various changeable inserts of different designs, see page 17.

Special inserts available upon customer's request.

#### Type FNW with morse taper

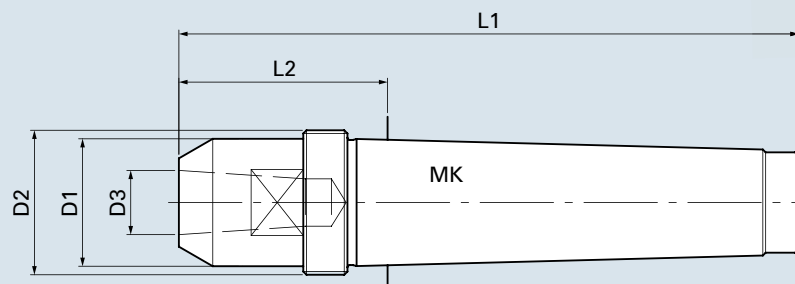

cat. no.	type	MK	D1	D2	D3	L1	L2
92301	FNW MK3	3	24	M27 x 1.5	16	121	40
92302	FNW MK4	4	32	M36 x 1.5	16	154.5	52
92303	FNW MK5	5	45	M48 x 1.5	22	190	60
92304	FNW MK6	6	64	M68 x 1.5	22	252	70

- true running accuracy at center cone: max. 0.01

Extracting nuts, see page 19 for accessories.

## Changeable Center Cone for RNA / FNA

### Clamping tools for clamping on machine tools

#### Center cones for large work piece centers

High degree of flexibility for clamping of work pieces with large centers.

Suitable for live centers type RNA on page 6 and for dead centers type FNA on page 13.

Special cones up to  $\varnothing 400$  available upon customer's request.

### For types RNA and FNA

cat. no.	W1	D1	D2	L
<b>81450</b>	60	20	85	60
<b>81451</b>	60	70	135	60
<b>81452</b>	60	120	185	60
<b>81453</b>	60	170	235	60
<b>81454</b>	60	220	285	60
<b>81455</b>	75	20	105	60
<b>81456</b>	75	90	175	60
<b>81457</b>	75	160	245	60
<b>81458</b>	75	230	315	60
<b>81459</b>	90	20	130	60
<b>81460</b>	90	100	210	60
<b>81461</b>	90	180	290	60

The center cones are fastened with a screw M8 DIN 912 onto the base body.

The center cones can be forced off with a screw M10.

For type RNA / FNA with SK30 interface

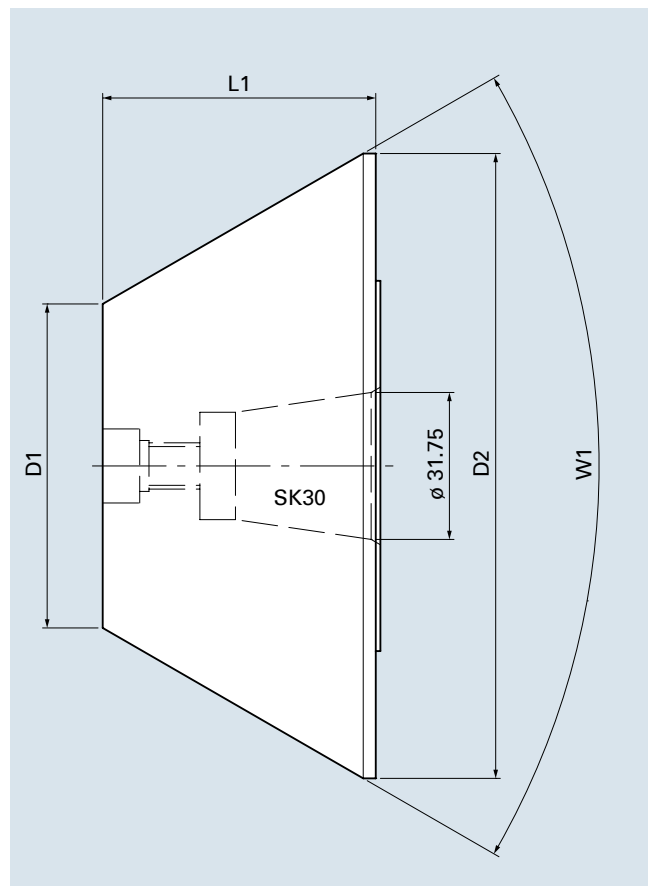



## Changeable Inserts for RNW / FNW

### Clamping tools for clamping on machine tools

#### Changeable inserts for a maximum of flexibility

The adaptation of various changeable inserts ensures a high degree of flexibility and saving of costs.

Suitable for live centers type RNW on page 7 and for the dead centers type FNW on page 13.

Special inserts available upon customer's request.

#### For types RNW 3 and 4 FNW MK3 and 4

cat. no.	type	D1	D2	D3	D4	L
81550	A	22	-	-	16	30
81551	B	22	10	-	16	40
81552	C	22	7	10	16	30
81553	D	22	11	-	16	30
81554	E	55	21	-	16	35
81555	F	55	50	10	16	30
81556	G	22	10	-	16	40

#### For types RNW 5 and 6 FNW MK5 and 6

cat. no.	type	D1	D2	D3	D4	L
81560	A	34	-	-	22	35
81561	B	34	16	-	22	45
81562	C	34	10	7	22	29
81563	D	34	18	-	22	35
81564	E	70	33	-	22	38
81565	F	70	64	24	22	34
81566	G	34	16	-	22	45

For type RNW / FNW with taper interface

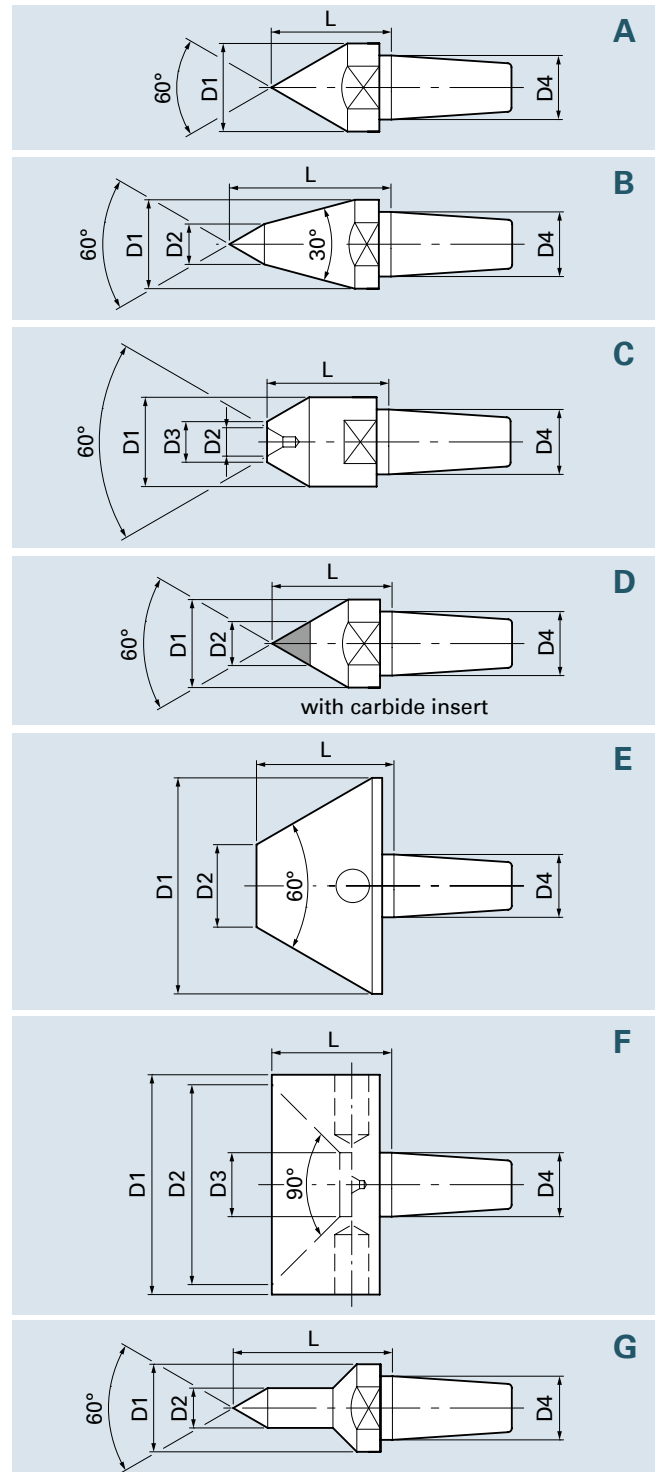

For quick demounting all changeable inserts come with spanner flat or cross hole.